

# S-SOD4004T-SH

Surface Mount Glass Passivated Junction Rectifiers  
Voltage 400V Forward Current 1.0A

## 1. FEATURES

- Plastic package has Underwriters Laboratory Flammability Classification 94V-0.
- High temperature metallurgically bonded construction.
- Cavity-free glass passivated junction.
- Capable of meeting environmental standards of MIL-S-19500.
- 1.0 A operation at TA=75°C with no thermal runaway
- Typical IR less than 1.0μA.
- High temperature soldering guaranteed:260°C/10 seconds.
- We declare that the material of product compliance with RoHS requirements and Halogen Free.
- S- prefix for automotive and other applications requiring unique site and control change requirements; AEC-Q101 qualified and PPAP capable.

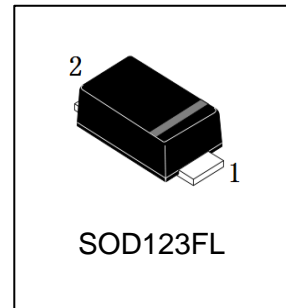

## 2. DEVICE MARKING AND ORDERING INFORMATION

Device	Marking	Shipping
S-SOD4004T-SH	A4T	3000/Tape&Reel

## 3. MAXIMUM RATINGS(Ta = 25°C)

Parameter	Symbol	Limits	Unit
Maximum repetitive peak reverse voltage	VRRM	400	V
Maximum RMS voltage	VRMS	280	V
Maximum DC blocking voltage	VDC	400	V
Maximum average forward rectified current lead length at TC = 75°C(Note 1)	IF(AV)	1	A
Peak forward surge current 8.3ms single half sine-wave superimposed on rated load (JEDEC Method)	IFSM	30	A
Reverse surger current(20mS)	IRSM	18	mA
Maximum reverse recovery time (Note 1)	trr	2100	ns
Typical thermal resistance (Note 2)	RθJA	170	°C/W
	RθJL	40	
Operating junction temperature range	TJ	-55 ~ +150	°C
Storage temperature range	TSTG	-55 ~ +150	°C

**4. ELECTRICAL CHARACTERISTICS (Ta= 25°C)**

Characteristic	Symbol	Min	Typ.	Max	Unit
Maximum instantaneous forward voltage at 1.0A	VF	-	-	1.1	V
Maximum DC reverse current TJ= 25°C	IR	-	-	5	μA
at rated DC blocking voltage TJ = 125°C		-	-	50	
Typical junction capacitance at 4.0V, 1MHz	CJ	-	15	-	pF

1. IF = 0.5A, IR = 1.0A, IRR = 0.25A

2. 8.0mm<sup>2</sup> (.013mm thick) land areas

## 5. ELECTRICAL CHARACTERISTICS CURVES

Fig. 1 - Forward Current Derating Curve

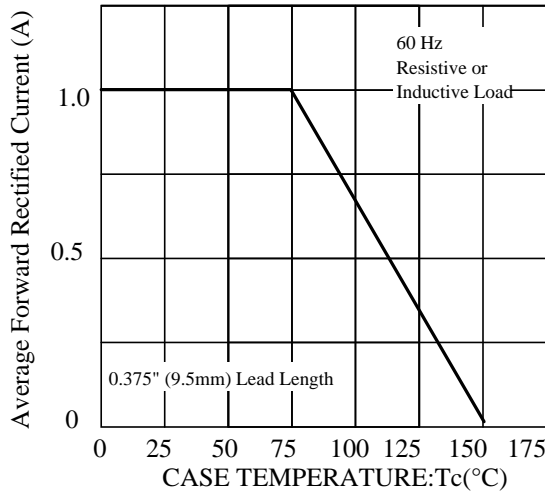

Fig. 2 - Maximum Non-repetitive Peak Forward Surge Current

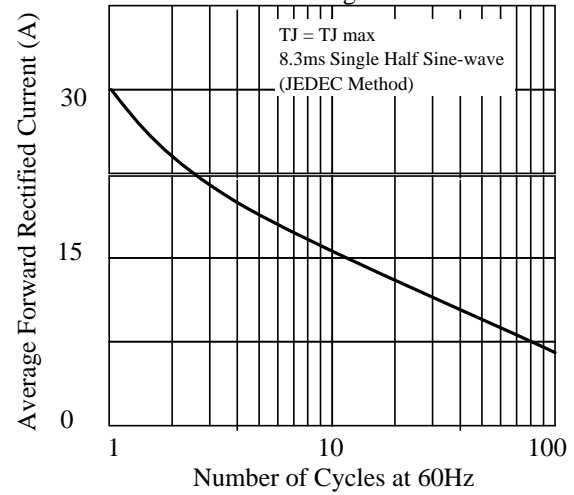

Fig 3. - Typical Instantaneous Forward Characteristics

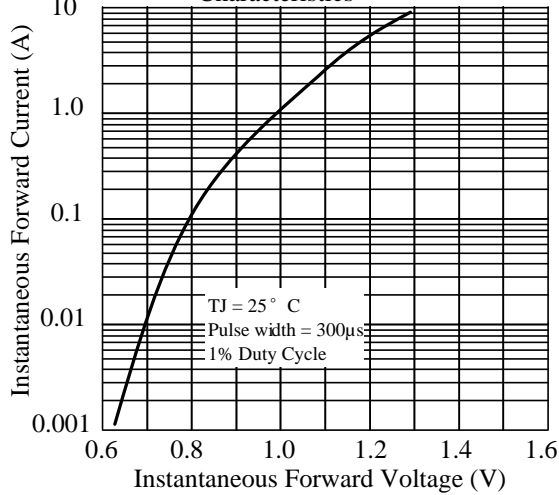

Fig 4. - Typical Reverse Characteristics

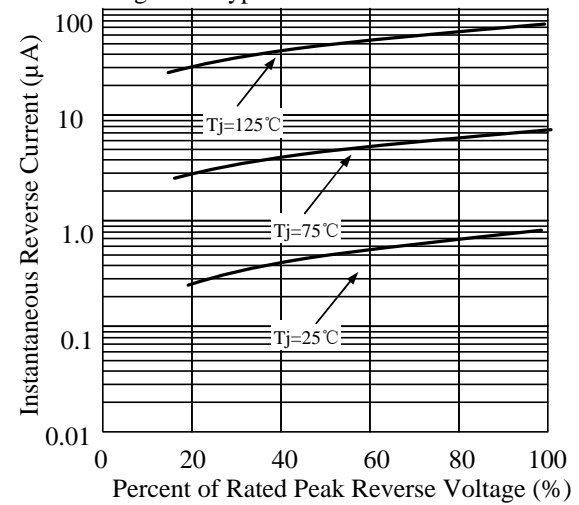

Fig 5. - typical transient thermal impedance

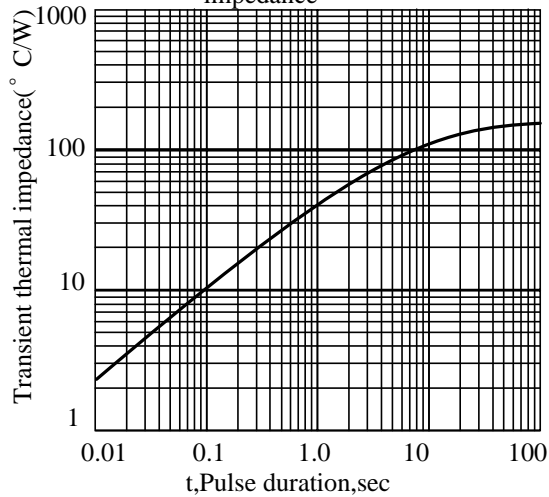
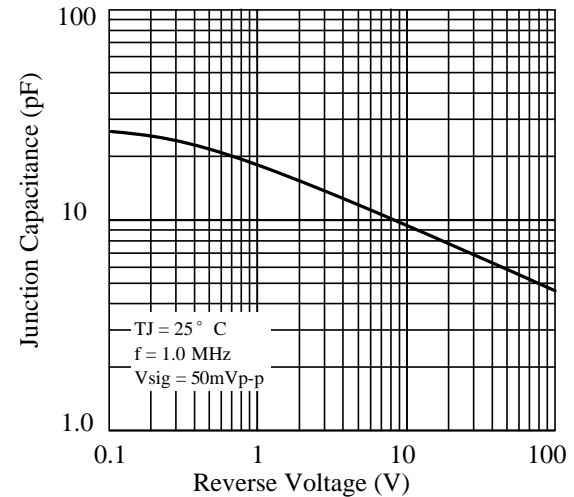
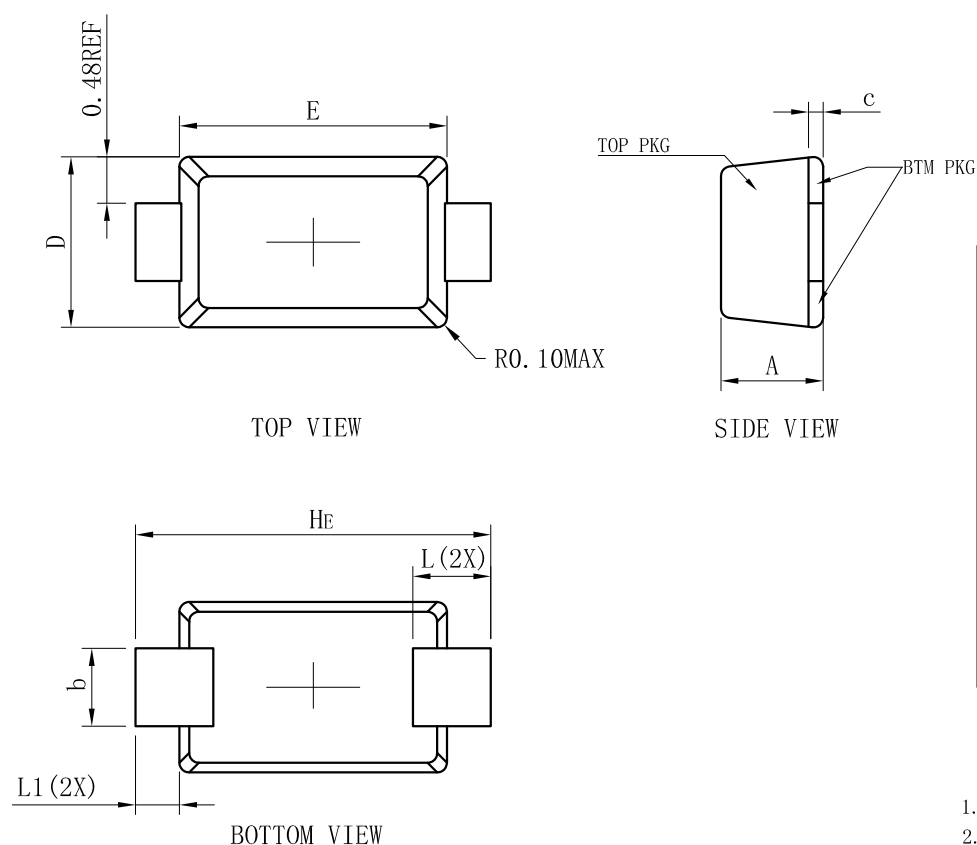

Fig 6. - Typical Junction Capacitance



## 6. OUTLINE AND DIMENSIONS



## 7.SOLDERING FOOTPRINT

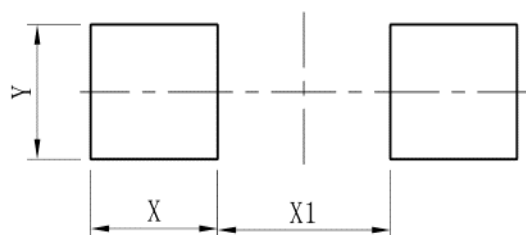

DIM	(mm)
X	1.20
Y	1.10
X1	2.00

## **DISCLAIMER**

- Before you use our Products, you are requested to carefully read this document and fully understand its contents. LRC shall not be in any way responsible or liable for failure, malfunction or accident arising from the use of any LRC's Products against warning, caution or note contained in this document.
- All information contained in this document is current as of the issuing date and subject to change without any prior notice. Before purchasing or using LRC's Products, please confirm the latest information with a LRC sales representative.